



Fitting Instructions For DG0037 DOWNPIPE GRILLE
HONDA CB500F 2019-



Picture A

THIS KIT CONTAINS THE ITEMS PICTURED AND LABELLED OVER PAGE.

SOME PARTS MAY BE SHOWN FOR CLARITY OF INSTRUCTIONS ONLY.

DO NOT PROCEED UNTIL YOU ARE SURE ALL PARTS ARE PRESENT.

PLEASE READ ALL INSTRUCTIONS BEFORE PROCEEDING.

IF IN ANY DOUBT WHEN FITTING OUR PRODUCTS, CONSULT ONE OF OUR DEALERS OR HAVE FITTED BY A QUALIFIED TECHNICIAN.

Please note that the way the kit is packed does not necessarily represent the way of mounting to the bike.

In the event of rubber washers being used to hold components onto bolts, these rubber washers can be thrown away.

DIGITAL COPIES OF THESE INSTRUCTIONS ARE AVAILABLE FROM

www.rg-racing.com

R&G Racing

Unit 1, Shelleys Lane, East Worldham, Alton, Hampshire GU34 3AQ.

Tel: +44 (0)1420 89007 Fax +44 (0)1420 87301 www.rg-racing.com Email: info@rg-racing.com



<u>TOOLS REQUIRED</u>	<u>GENERAL TORQUE SETTINGS</u>
<ul style="list-style-type: none"> • 4mm Allen. • 10mm spanner or socket. 	<p>M4 BOLT = 8Nm M5 BOLT = 12Nm M6 BOLT = 15Nm M8 BOLT = 20Nm M10 BOLT = 40Nm M12 BOLT = 40Nm</p>

LEGEND

ITEM NO.	DESCRIPTION	QTY
ITEM 1	DOWNPIPE GRILLE (DG0037)	1
ITEM 2	M6 x 35mm LONG BUTTON HEAD BOLTS	2
ITEM 3	M6 WASHERS	2
ITEM 4	M6 NYLOC NUTS	2

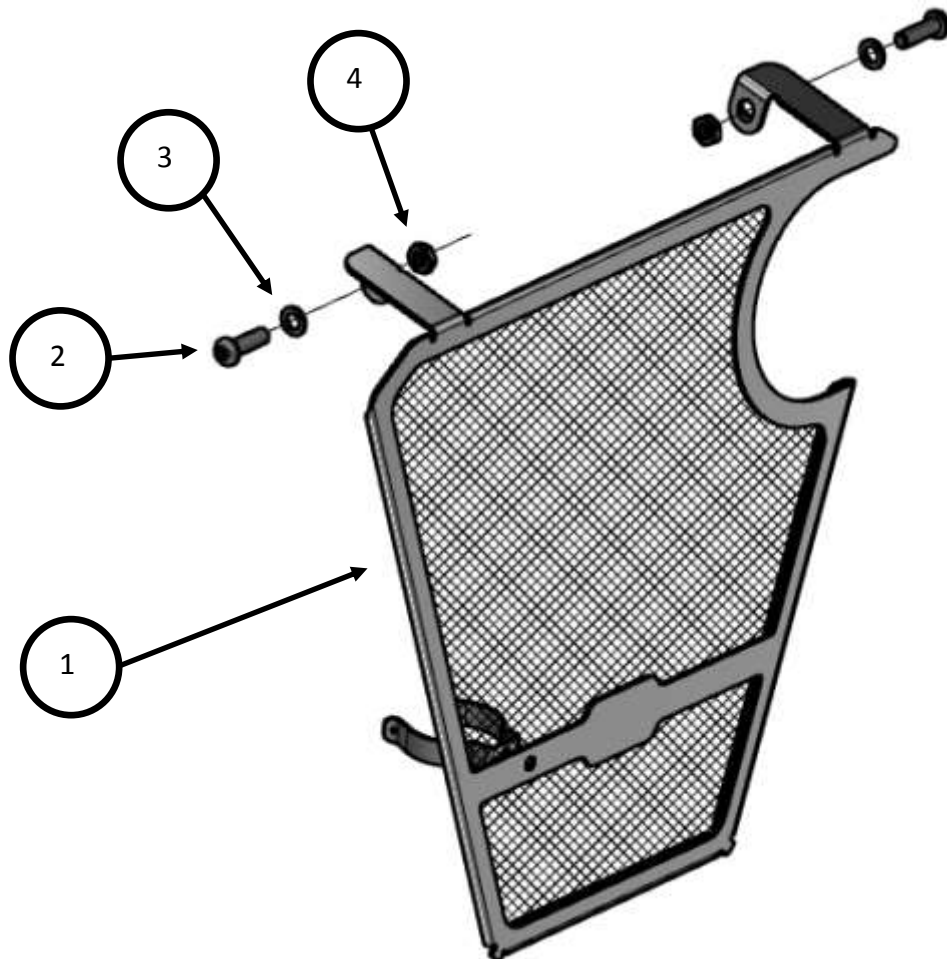

R&G Racing

Unit 1, Shelleys Lane, East Worldham, Alton, Hampshire GU34 3AQ.

Tel: +44 (0)1420 89007 Fax +44 (0)1420 87301 www.rg-racing.com Email: info@rg-racing.com

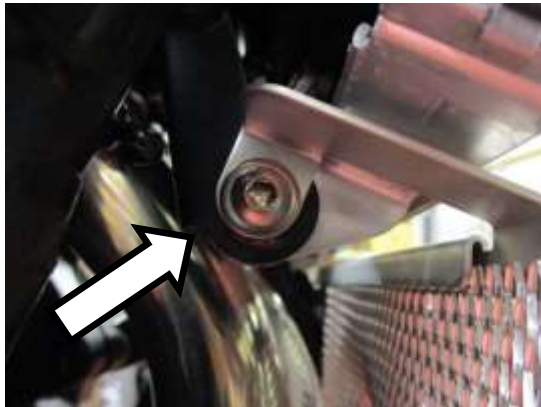

Picture 1



Picture 2

FITTING INSTRUCTIONS

- Offer the downpipe grille (item 1) into position under the radiator aligning the radiator mounts to the downpipe grille.
- Locate in position using the two button head bolts (item 2) with washers (item 3) as shown in pictures 1. The cut-out in the Downpipe Grille will fit around the horn.
- Fit two of the nyloc nuts (item 4) to the exposed ends of both threads and tighten.
- To fit the exhaust spring clip shown in picture 2, simply push onto exhaust.

Issue 2 03/12/2019 (BG)

CONSUMER NOTICE

The catalogue description and any exhibition of samples are only broad indications of the Products and R&G may make design changes which do not diminish their performance or visual appeal and supplying them in such state shall conform to the order. The Buyer acknowledges no representation or warranty (other than as to title) has been **given or will apply to the Products other than those in R&G's order or confirmation and the Buyer confirms it has chosen** the Products as being of merchantable quality and suitable for its particular purposes. Where R&G fits the Products or undertakes other services it shall exercise reasonable skill and care and rectify any fault free of charge unless the workmanship has been disturbed. The Buyer is responsible for ensuring that the warranty on the motorcycle is not affected by the fitting of the Products. On return of any defective Products R&G shall at its option either supply a replacement or refund the purchase money but shall not be liable if the Products have been modified or used or **maintained otherwise than in accordance with R&G's or manufacturer's instructions and good engineering practice** or if the defect arises from accident or neglect. Other than identified above and subject to R&G not limiting its liability for causing death and personal injury, it shall not be liable for indirect or consequential loss and otherwise its liability shall be limited to the amounts paid by the Buyer for the Products or the fitting or service concerned. These terms do **not affect the Buyer's statutory rights**.

R&G RACING RETURNS POLICY (NON-FAULTY GOODS)

Returns must be pre-authorized (if not pre-authorized the return will be rejected). Goods may only be returned direct to us if they were purchased direct from us (customer must prove if necessary). Otherwise to be returned to original vendor. Goods must be in re-sellable condition, in the opinion of R&G Racing. All returns are subject to a 25% re-stocking and handling fee (25% of the gross value exc. P&P – at the prevailing price at time of purchase). The cus-

R&G Racing

Unit 1, Shelleys Lane, East Worldham, Alton, Hampshire GU34 3AQ.

Tel: +44 (0)1420 89007 Fax +44 (0)1420 87301 www.rg-racing.com Email: info@rg-racing.com



NOTICE DE MONTAGE DG0037

GRILLE DE PROTECTION COLLECTEURS D'ÉCHAPPEMENT

HONDA CB500F 2019-



LE KIT CONTIENT LES ARTICLES EN PHOTO ET ÉTIQUETTES SUR LA PAGE

LES PARTIES PRÉSENTÉES PEUVENT ÊTRE UNIQUEMENT REPRÉSENTATIVES POUR LA CLARTÉ DES INSTRUCTIONS

NE PAS PROCÉDER AU MONTAGE AVANT DE VOUS ÊTRE ASSURÉ QUE TOUTES LES PIÈCES SOIENT PRÉSENTES.

SVP, LIRE L'ENSEMBLE DE LA NOTICE AVANT DE PROCÉDER AU MONTAGE.

EN CAS DE DOUTE LORS DU MONTAGE, CONSULTEZ UN DE NOS REVENDEURS, OU FAITES EFFECTUER LE MONTAGE PAR UN TECHNICIEN QUALIFIÉ.

LA FAÇON DONT LE KIT EST EMBALLÉ NE CORRESPOND PAS FORCÉMENT À LA FAÇON DE MONTER LES PIÈCES SUR LA MOTO .

NOTEZ QUE SI LES KITS SONT EMBALLÉS AVEC DES RONDELLES EN CAOUTCHOUC SERVANT À TENIR LES COMPOSANTS, CES RONDELLES DOIVENT ÊTRE JETÉES.

NOTICE DISPONIBLE AU TÉLÉCHARGEMENT SUR : WWW.RG-RACING.COM

R&G Racing

Unit 1, Shelleys Lane, East Worldham, Alton, Hampshire GU34 3AQ.

Tel: +44 (0)1420 89007 Fax +44 (0)1420 87301 www.rg-racing.com Email: info@rg-racing.com



<u>OUTILS REQUIS</u>	<u>VALEURS DE SERRAGE</u>
<ul style="list-style-type: none"> • Clés Allen 4 & 5mm. • Clé à cliquet + douilles 6, 8, 10 & 13mm. • Tournevis cruciforme. • Coupe câble. 	M4 BOULON = 8Nm M5 BOULON = 12Nm M6 BOULON = 15Nm M8 BOULON = 20Nm M10 BOULON = 40Nm

LEGENDE

ARTICLE NO.	DESCRIPTION	QTE
ARTICLE 1	GRILLE DE PROTECTION COLLECTEURS D'ÉCHAPPEMENT (DG0037)	1
ARTICLE	M6 x 35mm BOULONS	2
ARTICLE	M6 RONDELLES	2
ARTICLE	M6 ECROUS	2

NOTICE DE MONTAGE

- Monter la grille de protection des collecteurs d'échappement en position comme sur la photo 1 et montez-la à l'aide des vis et écrous fournis en vous assurant que la rondelle se place juste avant l'écrou.
- L'ouverture dans la grille s'adapte au klaxon.
- Pour monter les clips d'échappement à ressort illustrés sur la photo 2, appuyez simplement sur l'échappement.

Issue 1 28/08/2019 (BG)

R&G Racing

Unit 1, Shelleys Lane, East Worldham, Alton, Hampshire GU34 3AQ.

Tel: +44 (0)1420 89007 Fax +44 (0)1420 87301 www.rg-racing.com Email: info@rg-racing.com



MONTAGEANLEITUNG FÜR DG0037 KRÜMMERSCHUTZGITTER

HONDA CB500F 2019-



Abbildung A

Alle Kit-Teile sind unten abgebildet und gekennzeichnet

Die abgebildeten Teile dienen lediglich zur Erklärung.

Überprüfen Sie zuerst, dass alle Teile vorhanden sind.

Lesen Sie die Montageanleitung komplett durch, bevor Sie anfangen.

WENN SIE BEI DER MONTAGE DIESES PRODUKTES UNSICHER SIND , BITTE EINEN UNSERER HÄNDLER KONTAKTIEREN ODER DAS KIT VON EINEM QUALIFIZIERTEN ZWEIRAD-MECHANIKER MONTIEREN LASSEN.

Die Verpackung der Teile stellt nicht die Reihenfolge der Montage dar.

Hinweis für Kits mit Plastikunterlegscheiben an den Schrauben – Diese Plastik-Unterlegscheiben werden nicht für den Einbau benötigt!

EINE DIGITALE VERSION DIESER MONTAGEANLEITUNG KANN AUF FOLGENDER SEITE HERUNTERGELADEN WERDEN:

www.rg-racing.com

R&G Racing

Unit 1, Shelleys Lane, East Worldham, Alton, Hampshire GU34 3AQ.

Tel: +44 (0)1420 89007 Fax +44 (0)1420 87301 www.rg-racing.com Email: info@rg-racing.com



SIE BENÖTIGEN FOLGENDES WERKZEUG

- Satz Inbusschlüssel inkl. Größe 4 & 5mm A/F
 - 6, 8, 10 & 13mm Steckschlüssel
 - Kreuzschlitzschraubenzieher
 - Seitenschneider

ALLGEM. ANZUGSDREHMOMENT

- M4 SCHRAUBE = 8Nm
- M5 SCHRAUBE = 12Nm
- M6 SCHRAUBE = 15Nm
- M8 SCHRAUBE = 20Nm
- M10 SCHRAUBE = 40Nm

LIEFERUMFANG

ARTIKEL-NR.	BESCHREIBUNG	MENGE
ARTIKEL 1	KRÜMMERSCHUTZGITTER (DG0037)	1
ARTIKEL 2	M6 x 35mm INBUSSCHRAUBE	2
ARTIKEL 3	M6 UNTERLEGSCHIEBE	2
ARTIKEL 4	M6 SELBSTSICHERNDE MUTTER	2

MONTAGEANLEITUNG

- Das R&G Krümmerschutzgitter in Position bringen wie in Abbildung 1 abgebildet, und mit den Schrauben und Muttern vom Kit befestigen. Bitte darauf achten, dass die Unterlegscheibe vor der Mutter montiert wird.
- Der Ausschnitt im Krümmerschutzgitter umgreift die Hupe.
- Um die Federklemmen, die in Abbildung 2 abgebildet sind zu montieren, einfach auf den Auspuff aufstecken.

Ausgabe 1 28/08/2019 (BG)

R&G Racing

Unit 1, Shelleys Lane, East Worldham, Alton, Hampshire GU34 3AQ.

Tel: +44 (0)1420 89007 Fax +44 (0)1420 87301 www.rg-racing.com Email: info@rg-racing.com